

**TOUCH THE
FUTURE WITH US**

5X PRO

5X PRO



www.alfamill.com

İçindekiler

Contents

Hakkımızda	4
A-IS Pro 3 Lab Scanner	5
Intra Oral Scanner	6
CSF-200S Zircon Furnace	8
AMD 5D (Dry System)	10
AMD GP4 (Wet System)	12
AMD 5XPRO+ (Full System)	14
Cuttable Materials	16
Cutting Tools	17
Alfamill Online Shop	22

Hakkımızda

About Us

Touch The Future With Us

Faaliyet gösterdiğimiz Dental ve Endüstri sektöründe uluslararası standartlara ve belirtilen yönetmeliklere tam bir uyum içinde, en iyi şekilde çalışmalarımızı yürütmekle yükümlüyüz. Alfamill, güvenilir ve kaliteli hizmet anlayışıyla lider değil, öncü bir marka olmayı hedeflemektedir. Çalışmalarımıza bu temel ilkelerle başlıyor, yeni projeler geliştiriyor ve bu ilkelerden ödün vermeden projelerimizi tamamlıyoruz.

In the Dental and Industrial sector in which we operate, we are obliged to carry out our work in the best way, in full compliance with international standards and specified regulations. Alfamill aims to be a pioneering brand, not a leader, with a reliable and quality service approach. We start our work with these basic principles and we develop new projects and complete our projects without compromising these principles.



A-IS Pro 3 Lab Scanner



Aidite A-IS Pro 3 is a 3D dental scanner with many powerful functions for multiple applications covering scans of impressions, plaster models, articulators, implant abutments, etc. Its high-resolution cameras, advanced algorithms and user-friendly interface provide you with superior quality data, providing optimal results.

Technical Specifications

Model	A-IS Pro 3
Camera Resolution	2*5.0MP
Accuracy	$\leq 8 \mu\text{m}$
Scan Time	Bite scan: 7s; Upper/Lower jaw scan: 14s; 1-4 dies scan: 18s; 5-8 dies scan: 30s; Impresion scan: 66s
Articulator Scan	Support articulator transfer
Output Format	STL, PLY, OBJ
Light Source	Blue Light
Dimension	385*260*270 mm
Weight	5.0 Kg
Interface	USB 3.0
Power Supply	DV 24V

Advanced Desktop Scanner

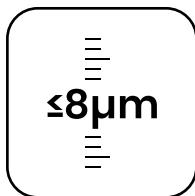

Ultra-high Accuracy

Scan accuracy less than $8 \mu\text{m}$ assures reliable scan result, satisfying the requirement of various applications in the dental industry.



Unparalleled Details

Equipped with dual 5.0 MP high resolution cameras, A-IS Pro 3 can capture every detail of the components meticulously.

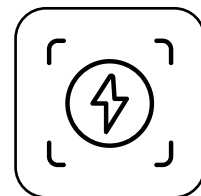

Fast Speed

Bite scan: 7s
Upper / Lower jaw scan: 14s
1-4 dies scan: 18s
5-8 dies scan: 30s
Impression scan: 66s

Intra Oral Scanner

Capture Digital Impressions in Real Time

20

Frames
Second

Faster Scan

Scans at up to 20 frames per second

Up To

22mm

Greater Scan Depth

The scan depth is 22mm² or less, which improves the scanning efficiency. And it is suitable for a variety of clinical scenarios, including scanning rod and periodontal scan, can be easily used.

0.05mm

More Accurate Scan

Thanks to optimized the software algorithm and imaging mechanism, the accuracy of Alfamill is 0.05mm or less for a single jaw, and the data is real and clear, which fully meets the needs of various clinical applications such as implantation, orthodontic and restoration.

Clinical Toolkit





Technical Specifications

Scan Field	Standard scanner tip: 16mm * 12mm * 22mm Mini scanner tip: 12mm * 9mm * 22mm
Scan Depth	-2-20mm from exit surface of tip
Scan Principle	Non-contact scanner with structured light
Dimension (L * W * H)	281mm * 33mm * 46mm
Weight	240± 10g (without cables)
Output	STL, OBJ, PLY
Connector	USB 3.0
Power Input	12V DC / 3A
Applications	Orthodontics, 6-Unit Bridge, Veneer, All-on-6 Implant, Inlay-onlay, Pediatric Dental Care

Recommended PC Configuration

Recommended PC Configuration	Intel Core i7-8700 or higher
Memory	16GB or higher
Hard Disk Drive	256GB SSD or above
Graphic Card (GPU)	NVIDIA RTX 2060 6GB or higher
Operating System	Windows 10 Professional (64-Bit) or later versions of Windows operating system
Display Resolution	1920 * 1080, 60Hz or higher
I / O Ports	More than 2 Type-a USB 3.0 (or higher) ports

CSF - 200S



CSF-200 is a special furnace for rapid sintering of zirconia materials. As a new generation product of cameo zirconia rapid sintering furnace, it has achieved a perfect match with Aidite cameo zirconia materials. At the same time, the design of opening the furnace at 900°C to cool down and the addition of intelligent management modules have improved the processing efficiency of dentures.

Product Parameters

Model	CSF-200s
Size (L*W*H)	330*470*700mm
Furnace Size	Ø70*80mm
Power Supply	220V / 50Hz
Rated Power	1.5kw
Heating Element	3 silicon carbide rods
Sintering Way	Fast / Slow Sintering
Fastest Sintering Time	2.5h
Number of Sintered Dentures (MAX)	30
Sintering Curve	20

UI Interface



Main Interface



Program Selection



Curve editing

High Purity Silicon Carbide Elements

	Color	ΔL	ΔC	ΔH
Ten Times Sintering	A3	0.7	0.6	0.6
Two Hundred Times Sintering	A3	0.7	0.6	0.6

Note: ΔL Value stands for brightness
 ΔC Value stands for saturation
 ΔH Value stands for tone

10

**Ten times
sintering**



200

**Two hundred
times sintering**



0%

**Cause no pollution on
zirconia material**

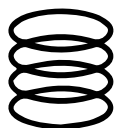

**Silicon carbide rod
life reminder**

Before the silicon carbide rod is about to reach its service life, remind to replace the silicon carbide rod in time, so as not to affect the sintering effect.

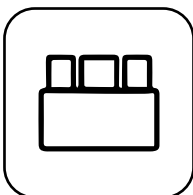

**The furnace can be
opened at 900°C**

Sped up the cooling, and the next sintering furnace can be started at 500°C, saving time.

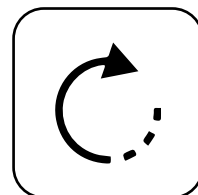

Breakpoint Continue

The sintering can be manually selected from the last interrupted program to avoid repetition.

AMD 5D

Alfamill AMD-5D 5 axis dental milling machine is mainly used for CAD/CAM processing of dental materials such as Zirconia, Pmma, Composite Material Etc. AMD-5D is easy to operate, and reliable in performance. It has All-in-one silica dust - proof design, and enable to do 90° vertical processing. Moreover, AMD-5D is equipped with 1/2 open fixture and plastic secondary fixture, which is effectively improving the material layout utilization, the functions like automatic calibration and smart alert brings you the ideal dental material processing solution.



Multiple Fixture, Fast Switch

- Combined with Secondary Fixture, Improving Material Utilizing Rate
- 98mm Disk Fixture (optional)
- Block Fixture (optional)

All-in-one air cast aluminium platform

- Body framework stable and durable
- Operation efficient
- Processing effect reliable



Modular Structure Design

- Platformization assembly, High precision
- Easy operation and routine maintenance
- Extend the usage life of equipment



Dust cover made by one-piece silicone

- Prevents dust from getting inside the machine
- Ensure high speed & accuracy, steady operation

Spindle

- The highest speed 60.000RPM
- Tools diameter: 2.0mm / 1.0mm / 1.5mm / 0.6mm / 0.3mm
- Shank diameter: 4mm



Large Angle / 90° Processing

- Rotational axis:
 - A AXIS: +135°, -30°
 - B AXIS: 360°
- 90° vertical processing on anterior teeth and buccal is available

Tool life management Function

- Real-time recording cutterlife
- Smart Alert for tool change
- 8 tools storehouse, meet production needs



Rotational axis harmonic drive

- Using high-precision, wide torque Harmonic drive
- Ensure the stability and precision of machining



Detail Effect

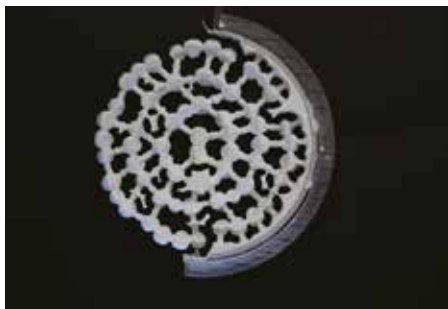
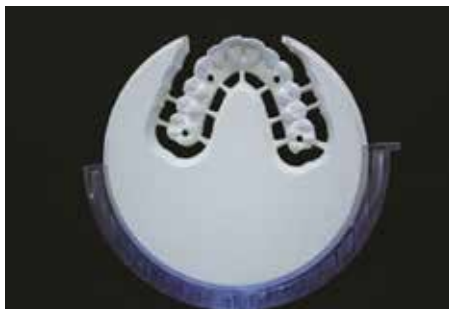

Equipment size	520*650*720mm
Processing method	Dry Mill
Dust proff	Integrated
Processing thickness	10-35mm
Machining type	Single crown, Bridge, Veneer, Inlay, Abutment, Full Contour Screw Retained Bridge
Machininh angle	A Axis : +135°, -30° B Axis : 360°
Spindle	Air Cooling Max : 60.000RPM 500W 4mm Chuck
Machining time	Full Crown <15min, Bridge <3h

AMD GP4

Alfamill AMD GP4 is a stable, high-precision, high-efficient wet milling machine. The equipment is easy to operate, adopts one-piece silicone protection, and a new fixture concept design. Bring you the ideal personalized abutment and glass ceramic processing solutions.

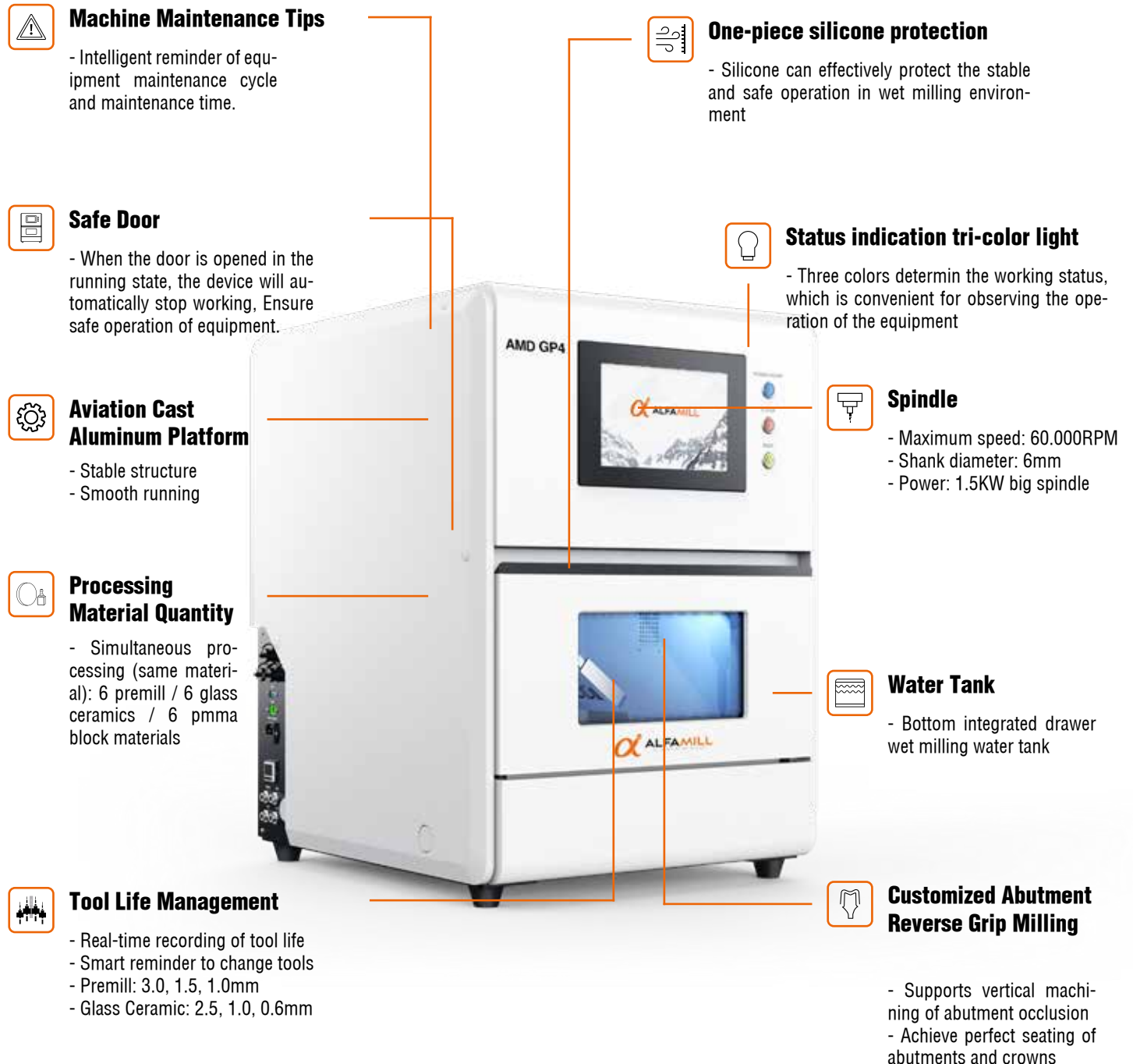

Detail Effect



High-precision control and brand-new structural design offer you a stable and efficient processing experience.



High precision lead screw

More stable control, better tooth surface effect

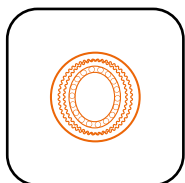

Modular structure design

Efficient and easy to maintain

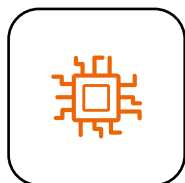

Harmonic drive

Harmonic drive to ensure high precision of machine



Platform	Aviation cast Aluminum
Size	590 * 730 * 820 (mm)
Weight	180kg
Processing method	Wet milling
Milling tool quantity	10 Pieces
Waterproof	One-piece silicone, good waterproof and airtight
Fixture	Block material fixture / reverse gripper fixture
Machinable material thickness	6 glass ceramic, 6 premill
Processed material	Premill, glass ceramics, PMMA and other wet milling block materials
Processing type	Crown and bridge, inlay, veneer, screw-retained crown, custom abutment
Nesting CAM software	Open
Processing Angle	B Axis: 360°
Motor	Bus servo and motor
Air Pressure	≥6 Bar
Function	Tool life management Working Status Indicator Safe door Flow detection function 90° vertical processing
Spindle	Water cooling MAX: 60.000RPM AC 1500W 6mm collet
Processing time	Premill ≤ 15min glass ceramic ≤ 20min

AMD 5XPRO+

Axis Motor Technology / Eksen Motor Teknolojisi	Absolute Servo Motor
Operating System / İşletim Sistemi	Linux
Block Holder Type / Blok Tutucu Tipi	C Holder / C Tutucu
Ball Screw Precision / Vidalı Mil Hassasiyeti	5 µ (c5)
Spindle Speed / İş Mili Hızı	60.000RPM / 3.2Kw
Number of Axis / Eksen Sayısı	5 Axis
Axis Movements / Eksen Hareketleri	210 * 120 * 110
A Axis Angle / A Eksen Açısı	+/- 360
B Axis Angle / B Eksen Açısı	+92 / -30
Max. Tilt Angle / Azami Eğim Açısı	±30 Degree
Tool Station / Frez Yuvası	20
Shank Diameter / Takım Şaft Çapı	6mm
Auto Cabin Wash / Otomatik Kabin Yıkama	Yes / Evet (Dry and Wet / Islak ve Kuru)
Touch Screen / Dokunmatik Ekran	10INCH
File Transfer / Dosya Paylaşımı	Wifi / Network / USB
CAM Software / CAM Yazılımı	Hyperdent - Millbox
Voltage - Frequency / Voltaj Frekans	110v-230v / 50-60Hz
Power Consumptions / Güç Tüketimi	Approximately / Ortalama 500W
Air Requirement / Hava Gereksinimi (Lt/Min)	250 (Lt / Min)
Compressed Air Pressure / Hava Basıncı (BAR)	6-8 Bar
Inner Volume (m³) / İç Hacim	0.25555
Dimensions / Ölçüler WDH (cm)	60 * 70 * 80
Weight / Ağırlık (kg)	280(kg)



TÜM ŞARTLARDA HERYERDEN DOSYA TRANSFERİ

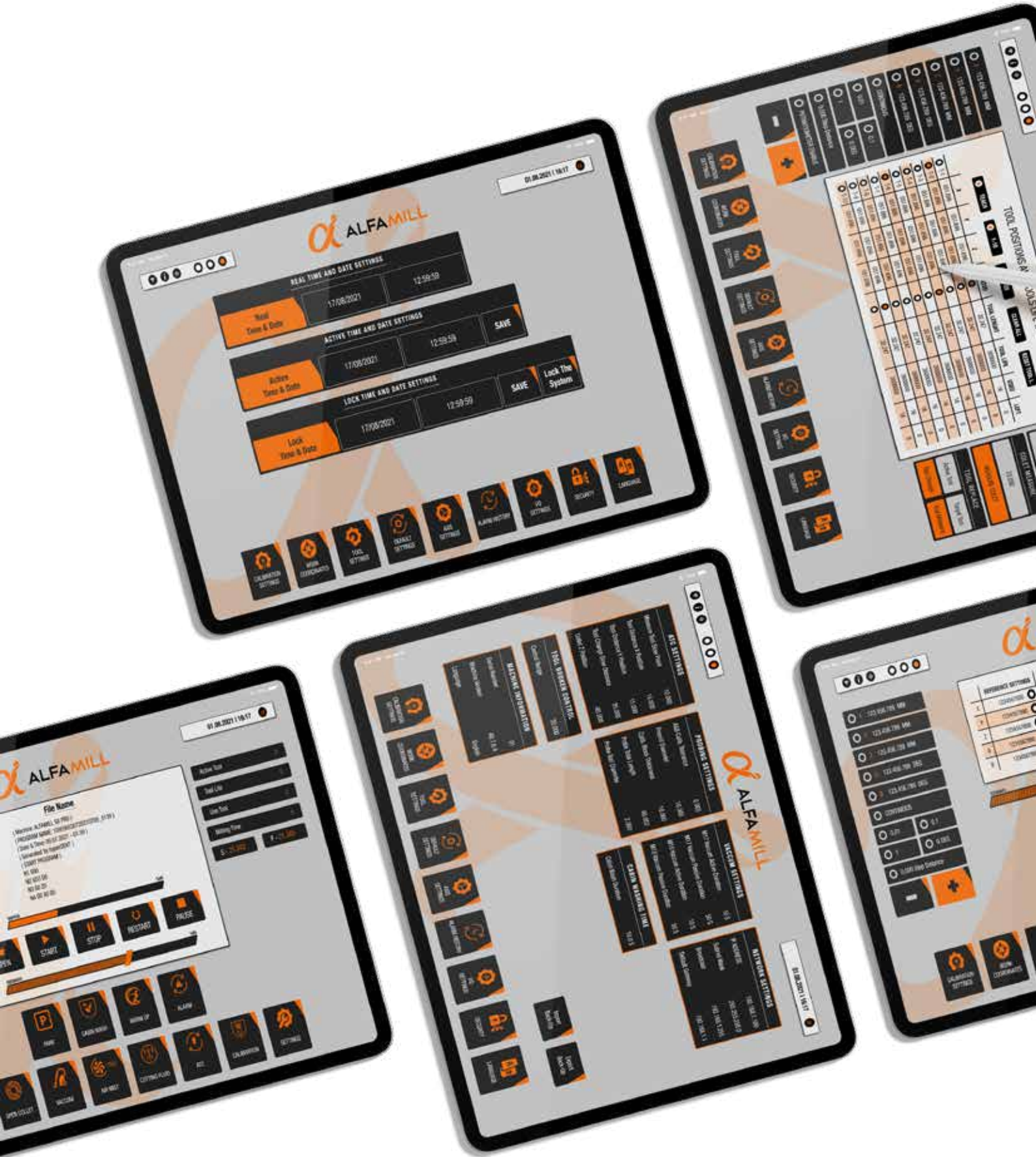

Kesilebilen Materyaller

Cuttable Material



**Hepsi
Tek Bir
Makina'da
All In
One
Machine**

Takımlar

Tools



Ball End

Specifically designed for machining organic shapes, available with different coatings and shapes for optimum performance on different materials.



Flat

Specially designed for a perfect finish on screw seatings and implant connections. The PerfoEdge side design gives the tools a significantly longer lifespan.



Bull Nose

Designed to give the tools a long lifespan, even for high-performance roughing jobs. The TiSi+ coating enables the milling of CoCr and titanium alloys.



Threading

With their reinforced cutting teeth and TiSi+ coating, Paragon threading tools are designed to achieve faster milling, with greater precision and a longer lifespan even on complex materials.



Varioaxis

The Paragon Tools T-Slots are the most advanced tools specifically designed for milling angled seatings and space for the screw in direct implant prostheses with angled channels.

Geometries



Flat



Ball End



Bull Nose



Threading



Varioaxis

Number of Flutes



Grinding



1



2



3



4

Coatings



Nano Diaomond

Cooling



Wet Milling



Dry Milling

NANO DIAMOND

Unrivalled performance

With their multilayer diamond coating of up to 15 microns, Paragon Nano Diamond tools last far longer than market standards. The Paragon Nano Diamond burs are intended for milling highly abrasive materials such as carbon fibre, fibreglass, nanocomposites, hybrid ceramics, presintered CoCr alloys and zirconium. The three-fold combination of the tools' very hard surface, low coefficient of friction and micro grain WC results in an increased lifespan of up to 900% compared with uncoated tools.



Coating Properties

Composition	C sp ³
Colour	Matte Black
Hardness	10000 HV0,05
Coefficient of friction	0,15
Thickness	15µm
Max. temp. for use	700° C

DIAMOND-LIKE-CARBON

Impressive results on difficult materials

The popularisation in the dental sector of complex machining materials such as PEEK or certain polymers has forced the redesign of burs to enable chip removal, to prevent the material from heating up and to avoid the burs breaking. The combination of burs with sharper cutting edges, fewer teeth and DLC coating has meant a revolution in the milling of polymers: the DLC's low coefficient of friction enables much higher machining speeds and keeps the cutting edge sharp for longer, resulting in better performance and surface finishing.



Coating Properties

Composition	ta- C
Colour	Glossy Grey
Hardness	5300 HV0,05
Coefficient of friction	0,12
Thickness	1-2µm
Max. temp. for use	500° C

TiSi+

Maximum productivity in CoCr and titanium milling

TiSi+ is a silicon nitride matrix into which nanocrystals of titanium aluminum nitride are deposited, forming a very hard nanocomposite ceramic coating. TiSi+ coated tools are extremely resistant to wear and oxidation, allowing high machining speeds without the need for liquid cooling. Even the machining of complex alloys of titanium, nickel and CoCr is easy when using TiSi+ coated tools.



Coating Properties

Composition	TiAlSiN
Colour	Iridescent Blue / Green
Hardness	4000 HV0,05
Coefficient of friction	0,5
Thickness	4µm
Max. temp. for use	1100° C

DED

Optimised for Lithium Disilicate and Ceramics

The DED coating is formed by a layer of synthetic diamond crystals adhered by electrodeposition. The tools are made with optimised grain for lithium disilicate and glass ceramics which extends their lifespan and produces exceptional surface results.



PMMA, PEEK

Maximum performance in polymer machining. Designed with positive shear angle and low-friction coating for optimum chip removal and reduced temperature in the cutting area, resulting in a higher milling speed, better surface finish and considerably longer lifespan.

Uses: PMMA, PEEK, Wax, Nanocomposite, Pu,Pa.

Reference	d	D	l1
C653 - 1NB0607	6	0.6	7
C653 - 1NB1016	6	1	16
C653 - 1NB2520	6	2.5	20

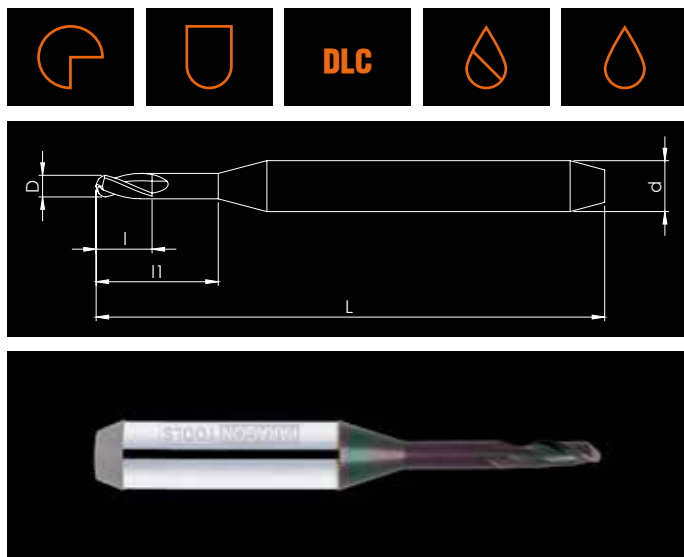

ZIRCONIA

A better performance thanks to their helix shape and diamond coating. The three-fold combination of the tools' very hard surface, low coefficient of friction and micro grain WC results in an increased lifespan of up to 9 times more than uncoated tools.

Uses: Zirconia, Pre-sintered CoCr, Carbon Fiber, Fiberglass.

Reference	d	D	l1	Z	Coating
C650-2NB03TA	6	0.3			DLC
D653-2NB0607	6	0.6	7	2	Nano Diamond
D653-2NB1016	6	1	16	2	Nano Diamond
D653-2NB2020	6	2	20	2	Nano Diamond
D653-2NB2520	6	2.5	20	2	Nano Diamond

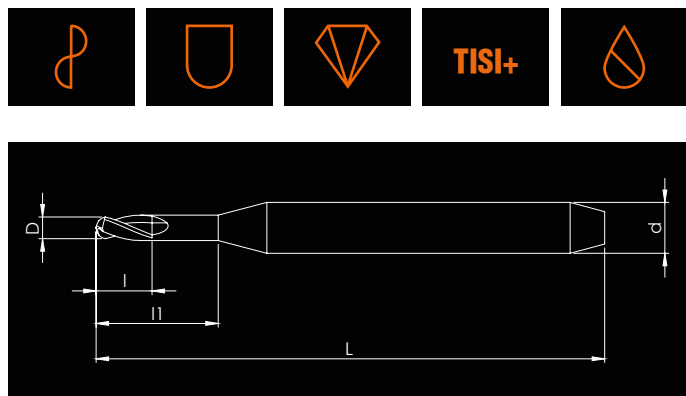

GLASS CERAMICS

Designed to give maximum performance in the manufacture of vitreous ceramics fillings. DED coating with optimised grain size and maximum adhesion.

Uses: Glass Ceramics, Lithium Disilicate, Lithium Disilicate.

Reference	d	D	l1	I	L
G640-01B2515	6	2.5	15	-	40
G640-01B1010	6	1.0	10	-	40
G640-01B0606	6	0.6	6	-	40

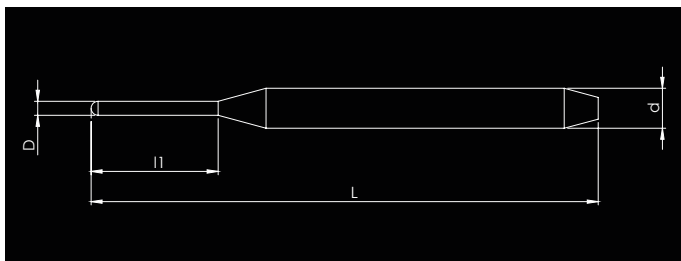

TITANIUM, CoCr

Designed for maximum productivity with CoCr and titanium. The combination of high helix angle with Tisi+ coating enables exceptional durability and cutting speeds even in dry milling. Optimised for machining complex titanium, nickel and CoCr alloys.

Uses: Glass Ceramics, Lithium Disilicate, Lithium Disilicate.

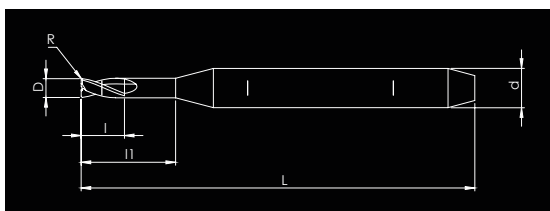

Reference	d	D	l1	Z
T650-21B0504	6	0.5	4	2
T650-31B1010	6	1	10	3
T650-31B1012	6	1	12	3
T650-31B1512	6	1.5	12	3
T650-31B1516	6	1.5	16	3
T650-21B2012	6	2	12	3
T650-31B2016	6	2	16	3
T650-31B3016	6	3	16	4
T650-31B3020	6	3	20	3



BİLGİ İÇİN İLETİŞİME GEÇEBİLİRSİNİZ
www.shopandmill.com

**Haziran Sonuna kadar olan %20
indirim fırsatı için kayıt olun**



İletişime Geç

Eyüp Sultan Mahallesi
Hoşnut Sok.No :8-B
Sancaktepe/İstanbul

E-Mail: info@alfamill.com
Telefon: +90 216 632 25 32
Web Site: www.alfamill.com